

# Stride Family Kits Ordering Information



PreStride



FullStride



SafetyStride

Maximize Your Options  
Maximize Your Outcomes



P: 800-521-2192 • 248-588-7480

F: 800-923-2537 • 248-588-2960

**Central Fabrication**

F: 248-588-4555

**BeckerOrthopedic.com**



# PreStride™

The PreStride is an evaluation tool that may be used in combination with a physical examination to assess candidacy for Stride stance control orthotic management. The PreStride is a modular and fully adjustable stance control KAFO that may be fitted to most adults who are between 5' 2" and 6' 2" in height. The overall height of the orthosis is easily adjusted by releasing the spring loaded knobs located on the medial and lateral uprights. Calf and thigh bands are also easily adjusted for varying A-P depths.

The PreStride, model 9007, comes with FullStride™ stance control knee joints and an optional GX-Assist unit to accommodate individuals with significant weakness of hip musculature. The GX-Assist uses a pneumatic spring to assist in knee extension by mimicking the swing phase function of the quadriceps muscle group. Model 9007 also offers interchangeability with the SafetyStride™ stance control knee joint (sold separately), which has the ability of resisting knee flexion at any angle and does not require full 180° knee extension in order to lock.

An additional advantage of the PreStride is that it may be used as an effective gait training tool during rehabilitation.

## PreStride Stance Control Assessment Orthosis

Order No.	Side
9007-R	Right
9007-L	Left
9007-P	Pair



## Optional SafetyStride Midsection

Order No.	Description	Side
9005-A6MS-R-PRESTRIDE	SafetyStride Midsection	Right
9005-A6MS-L-PRESTRIDE	SafetyStride Midsection	Left

# FullStride™ A Size

The FullStride is a mechanical stance control orthotic knee joint that utilizes a low-profile cabling system to automatically unlock at the end of stance phase. At the end of swing phase, when the orthotic knee joint reaches full extension, the locking mechanism re-engages to provide knee stability for stance phase.



Molding dummies are available for the FullStride and SafetyStride. Both systems utilize the same, universal, nylon molding dummy, which can be used on the right or left side. Sold individually.

## FullStride Molding Dummy

Order No.	Description
9006-MD-A	FullStride A Size Molding Dummy

—References the difference in component selection in each kit.



**A**—Heel Cable Receptor

## FullStride A Size Kit with Heel Cable Receptor

Order No.	Joint Size	Upright Dimensions	Upright Material
9006-A6	A	3/16" x 3/4"	Aluminum
9006-A6S	A	3/16" x 3/4"	Stainless Steel
9006-A6TI	A	3/16" x 3/4"	Titanium

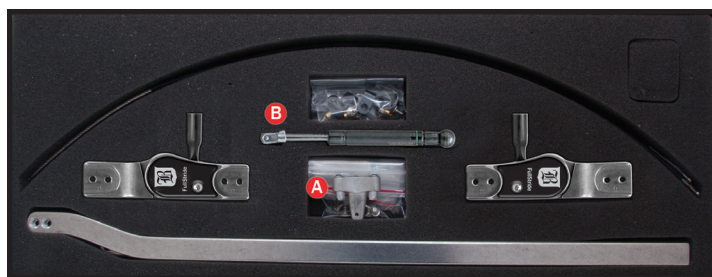

- A** — Heel Cable Receptor
- B** — GX-Assist

### FullStride A Size Kit with Heel Cable Receptor and GX-Assist

Order No.	Joint Size	Upright Dimensions	Upright Material	Side
9006-GX-A6-R- <b>X</b>	A	3/16" x 3/4"	Aluminum	Right
9006-GX-A6S-R- <b>X</b>	A	3/16" x 3/4"	Stainless Steel	Right
9006-GX-A6TI-R- <b>X</b>	A	3/16" x 3/4"	Titanium	Right
9006-GX-A6-L- <b>X</b>	A	3/16" x 3/4"	Aluminum	Left
9006-GX-A6S-L- <b>X</b>	A	3/16" x 3/4"	Stainless Steel	Left
9006-GX-A6TI-L- <b>X</b>	A	3/16" x 3/4"	Titanium	Left

The "**X**" in the part numbers listed above refer to the GX-Assist option you wish to be included with your kit. GX-Assist units are available in 75N, 125N and 175N. For example, to order a FullStride kit with aluminum uprights and a 125N GX-Assist for the right leg, your order number would be 9006-GX-A6-R-**125**.



- A** — Y-Stirrup
- B** — Double Action Ankle Joints

### FullStride A Size Kit with Y Stance Control Stirrups and Modular Double Action Ankle Joints

Order No.	Joint Size	Upright Dimensions	Upright Material
SCSY-9006-A6	A	3/16" x 3/4"	Aluminum
SCSY-9006-A6S	A	3/16" x 3/4"	Stainless Steel
SCSY-9006-A6TI	A	3/16" x 3/4"	Titanium



- A** — Y-Stirrup
- B** — GX-Assist
- C** — Double Action Ankle Joints

### FullStride A Size Kit with Y Stance Control Stirrups, Modular Double Action Ankle Joints and GX-Assist

Order No.	Joint Size	Upright Dimensions	Upright Material	Side
SCSY-9006-GX-A6-R- <b>X</b>	A	3/16" x 3/4"	Aluminum	Right
SCSY-9006-GX-A6S-R- <b>X</b>	A	3/16" x 3/4"	Stainless Steel	Right
SCSY-9006-GX-A6TI-R- <b>X</b>	A	3/16" x 3/4"	Titanium	Right
SCSY-9006-GX-A6-L- <b>X</b>	A	3/16" x 3/4"	Aluminum	Left
SCSY-9006-GX-A6S-L- <b>X</b>	A	3/16" x 3/4"	Stainless Steel	Left
SCSY-9006-GX-A6TI-L- <b>X</b>	A	3/16" x 3/4"	Titanium	Left

The "**X**" in the part numbers listed above refer to the GX-Assist option you wish to be included with your kit. GX-Assist units are available in 75N, 125N and 175N. For example to order a FullStride kit with Y stirrups, aluminum uprights and a 125N GX-Assist for the right leg, your order number would be SCSY-9006-GX-A6-R-**125**.



- A** — Stirrup
- B** — Double Action Ankle Joints

### FullStride A Size Kit with Stance Control Stirrup and Modular Double Action Ankle Joints

Order No.	Joint Size	Upright Dimensions	Upright Material
SCS <b>X</b> -9006-A6	A	3/16" x 3/4"	Aluminum
SCS <b>X</b> -9006-A6S	A	3/16" x 3/4"	Stainless Steel
SCS <b>X</b> -9006-A6TI	A	3/16" x 3/4"	Titanium

The "**X**" in the part number listed above refers to the stirrup size you wish to be included with your kit. Stirrups are available in 9", 10" and 11" lengths. For example to order a FullStride kit with aluminum uprights and a 9" stirrup, your order number would be SCS**9**-9006-A6.

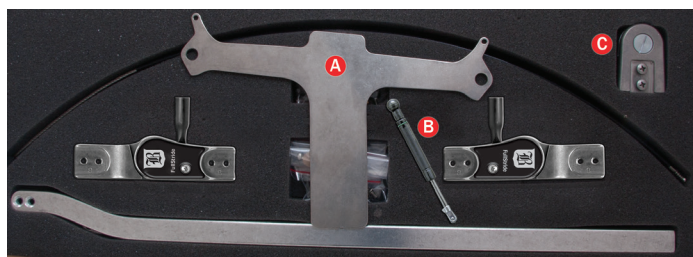

- A** — Stirrup
- B** — GX-Assist
- C** — Double Action Ankle Joints

### FullStride A Size Kit with Stance Control Stirrup, Modular Double Action Ankle Joints and GX-Assist

Order No.	Joint Size	Upright Dimensions	Upright Material	Side
SCSX-9006-GX-A6-R-X	A	3/16" x 3/4"	Aluminum	Right
SCSX-9006-GX-A6S-R-X	A	3/16" x 3/4"	Stainless Steel	Right
SCSX-9006-GX-A6TI-R-X	A	3/16" x 3/4"	Titanium	Right
SCSX-9006-GX-A6-L-X	A	3/16" x 3/4"	Aluminum	Left
SCSX-9006-GX-A6S-L-X	A	3/16" x 3/4"	Stainless Steel	Left
SCSX-9006-GX-A6TI-L-X	A	3/16" x 3/4"	Titanium	Left

The "X's" in the part numbers listed above refer to the stirrup size and the GX-Assist option you wish to be included with your kit. Stirrups are available in 9", 10" and 11" lengths and GX-Assist units are available in 75N, 125N and 175N. For example, to order a FullStride kit with aluminum uprights, 9" stirrup, and a 125N GX-Assist for the right leg, your order number would be SCS**9**-9006-GX-A6-R-**125**.

## FullStride™ A Size Custom KAFO's

Order No.	Description
322	FullStride KAFO - A Size
322-GX	FullStride KAFO w/ GX-Assist - A Size
322-PP	PrePreg FullStride KAFO - A Size
322-GX-PP	PrePreg FullStride KAFO w/ GX-Assist - A Size



# FullStride™ B Size

The FullStride is also available in our “B,” or youth size for smaller adults and adolescents. Offering a 25% reduction in weight to enhance the clinical application, the “B” size FullStride gives you additional possibilities in offering stance control to your patients.

The FullStride is a mechanical stance control orthotic knee joint that utilizes a low-profile cabling system to automatically unlock at the end of stance phase. At the end of swing phase, when the orthotic knee joint reaches full extension, the locking mechanism re-engages to provide knee stability for stance phase.



—References the difference in component selection in each kit.



A — Heel Cable Receptor

**FullStride B Size Kit with Heel Cable Receptor**

Order No.	Joint Size	Upright Dimensions	Upright Material
9006-B6	B	3/16" x 5/8"	Aluminum
9006-B6S	B	3/16" x 5/8"	Stainless Steel



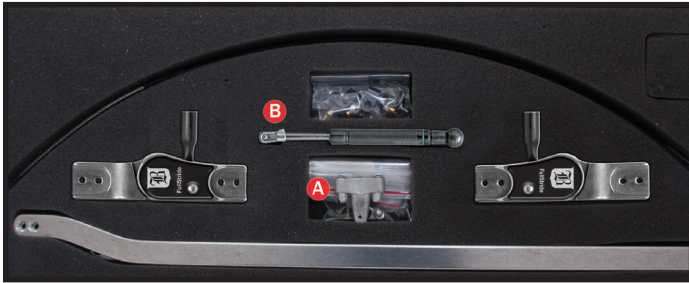

- A** — Heel Cable Receptor
- B** — GX-Assist

**FullStride B Size Kit with Heel Cable Receptor and GX-Assist**

Order No.	Joint Size	Upright Dimensions	Upright Material	Side
9006-GX-B6-R- <b>X</b>	B	3/16" x 5/8"	Aluminum	Right
9006-GX-B6S-R- <b>X</b>	B	3/16" x 5/8"	Stainless Steel	Right
9006-GX-B6-L- <b>X</b>	B	3/16" x 5/8"	Aluminum	Left
9006-GX-B6S-L- <b>X</b>	B	3/16" x 5/8"	Stainless Steel	Left

The "X" in the part numbers listed above refer to the GX-Assist option you wish to be included with your kit. GX-Assist units are available in 75N, 125N and 175N. For example, to order a FullStride kit with aluminum uprights and a 125N GX-Assist for the right leg, your order number would be 9006-GX-B6-R-**125**.



- A** — Y-Stirrup
- B** — Double Action Ankle Joints

**FullStride B Size Kit with Y Stance Control Stirrups and Modular Double Action Ankle Joints**

Order No.	Joint Size	Upright Dimensions	Upright Material
SCSY-9006-B6	B	3/16" x 5/8"	Aluminum
SCSY-9006-B6S	B	3/16" x 5/8"	Stainless Steel





### FullStride B Size Kit with Y Stance Control Stirrups, Modular Double Action Ankle Joints and GX-Assist

Order No.	Joint Size	Upright Dimensions	Upright Material	Side
SCSY-9006-GX-B6-R- <b>X</b>	B	3/16" x 5/8"	Aluminum	Right
SCSY-9006-GX-B6S-R- <b>X</b>	B	3/16" x 5/8"	Stainless Steel	Right
SCSY-9006-GX-B6-L- <b>X</b>	B	3/16" x 5/8"	Aluminum	Left
SCSY-9006-GX-B6S-L- <b>X</b>	B	3/16" x 5/8"	Stainless Steel	Left

The "**X**" in the part numbers listed above refer to the GX-Assist option you wish to be included with your kit. GX-Assist units are available in 75N, 125N and 175N. For example, to order a FullStride kit with Y stirrups, aluminum uprights and a 125N GX-Assist for the right leg, your order number would be SCSY-9006-GX-B6-R-**125**.



### FullStride B Size Kit with Stance Control Stirrup and Modular Double Action Ankle Joints

Order No.	Joint Size	Upright Dimensions	Upright Material
SCS <b>X</b> -9006-B6	B	3/16" x 5/8"	Aluminum
SCS <b>X</b> -9006-B6S	B	3/16" x 5/8"	Stainless Steel

The "**X**" in the part numbers listed above refer to the stirrup size you wish to be included with your kit. Stirrups are available in 9", 10" and 11" lengths. For example, to order a FullStride kit with aluminum uprights and a 9" stirrup, your order number would be SCS**9**-9006-B6.

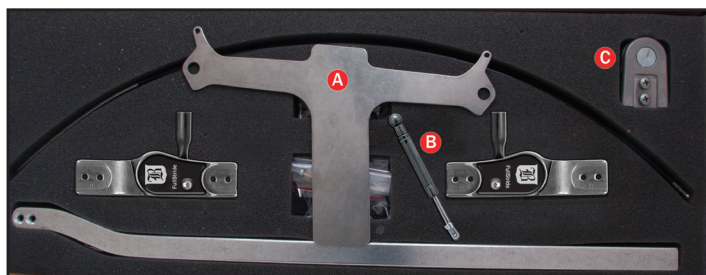

- A** — Stirrup
- B** — GX-Assist
- C** — Double Action Ankle Joints

### FullStride B Size Kit with Stance Control Stirrup, Modular Double Action Ankle Joints and GX-Assist

Order No.	Joint Size	Upright Dimensions	Upright Material	Side
SCSX-9006-GX-B6-R-X	B	3/16" x 5/8"	Aluminum	Right
SCSX-9006-GX-B6S-R-X	B	3/16" x 5/8"	Stainless Steel	Right
SCSX-9006-GX-B6-L-X	B	3/16" x 5/8"	Aluminum	Left
SCSX-9006-GX-B6S-L-X	B	3/16" x 5/8"	Stainless Steel	Left

The "X"s in the part numbers listed above refer to the stirrup size and the GX-Assist option you wish to be included with your kit. Stirrups are available in 9", 10" and 11" lengths and Gx-Assist units are available in 75N, 125N and 175N. For example, to order a FullStride kit with aluminum uprights, 9" stirrup, and a 125N GX-Assist for a right leg, your order number would be SCS9-9006-GX-B6-R-125.

## FullStride™ B Size Custom KAFO's

Order No.	Description
322-B	FullStride KAFO - B Size
322-GX-B	FullStride KAFO w/ GX-Assist - B Size
322-PP-B	PrePreg FullStride KAFO - B Size
322-GX-PP-B	PrePreg FullStride KAFO w/ GX-Assist - B Size



# SafetyStride™

The SafetyStride is a mechanical stance control orthotic knee joint that utilizes a low-profile cabling system to automatically unlock itself at the end of stance phase. The key feature of the SafetyStride is its ability to resist knee flexion at any angle. The SafetyStride does not require full 180° knee extension to resist knee flexion in stance phase. **US Patent No. 7,462,159 B1**



Molding dummies are available for the FullStride and SafetyStride. Both systems utilize the same, universal, nylon molding dummy, which can be used on the right or left side. Sold individually.

## FullStride Molding Dummy

Order No.	Description
9006-MD-A	SafetyStride Molding Dummy

**A**—References the difference in component selection in each kit.



**A**—Heel Cable Receptor

## SafetyStride Kit with Heel Cable Receptor

Order No.	Joint Size	Upright Dimensions	Upright Material	Side
9005-A6-R	A	3/16" x 3/4"	Aluminum	Right
9005-A6S-R	A	3/16" x 3/4"	Stainless Steel	Right
9005-A6TI-R	A	3/16" x 3/4"	Titanium	Right
9005-A6-L	A	3/16" x 3/4"	Aluminum	Left
9005-A6S-L	A	3/16" x 3/4"	Stainless Steel	Left
9005-A6TI-L	A	3/16" x 3/4"	Titanium	Left

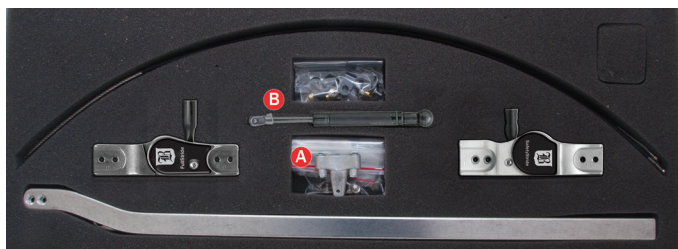

- A**—Heel Cable Receptor
- B**—GX-Assist

### SafetyStride Kit with Heel Cable Receptor and GX-Assist

Order No.	Joint Size	Upright Dimensions	Upright Material	Side
9005-GX-A6-R- <b>X</b>	A	3/16" x 3/4"	Aluminum	Right
9005-GX-A6S-R- <b>X</b>	A	3/16" x 3/4"	Stainless Steel	Right
9005-GX-A6TI-R- <b>X</b>	A	3/16" x 3/4"	Titanium	Right
9005-GX-A6-L- <b>X</b>	A	3/16" x 3/4"	Aluminum	Left
9005-GX-A6S-L- <b>X</b>	A	3/16" x 3/4"	Stainless Steel	Left
9005-GX-A6TI-L- <b>X</b>	A	3/16" x 3/4"	Titanium	Left

The "**X**" in the part numbers listed above refer to the GX-Assist option you wish to be included with your kit. GX-Assist Units are available in 75N, 125N and 175N. For example, to order a SafetyStride kit with aluminum uprights and a 125N GX-Assist for the right leg, your order number would be 9005-GX-A6-R-**125**.



- A**—Y-Stirrup
- B**—Double Action Ankle Joints

### SafetyStride Kit with Y Stance Control Stirrups and Modular Double Action Ankle Joints

Order No.	Joint Size	Upright Dimensions	Upright Material	Side
SCSY-9005-A6-R	A	3/16" x 3/4"	Aluminum	Right
SCSY-9005-A6S-R	A	3/16" x 3/4"	Stainless Steel	Right
SCSY-9005-A6TI-R	A	3/16" x 3/4"	Titanium	Right
SCSY-9005-A6-L	A	3/16" x 3/4"	Aluminum	Left
SCSY-9005-A6S-L	A	3/16" x 3/4"	Stainless Steel	Left
SCSY-9005-A6TI-L	A	3/16" x 3/4"	Titanium	Left



### SafetyStride Kit with Y Stance Control Stirrups, Modular Double Action Ankle Joints and GX-Assist

Order No.	Joint Size	Upright Dimensions	Upright Material	Side
SCSY-9005-GX-A6-R- <b>X</b>	A	3/16" x 3/4"	Aluminum	Right
SCSY-9005-GX-A6S-R- <b>X</b>	A	3/16" x 3/4"	Stainless Steel	Right
SCSY-9005-GX-A6TI-R- <b>X</b>	A	3/16" x 3/4"	Titanium	Right
SCSY-9005-GX-A6-L- <b>X</b>	A	3/16" x 3/4"	Aluminum	Left
SCSY-9005-GX-A6S-L- <b>X</b>	A	3/16" x 3/4"	Stainless Steel	Left
SCSY-9005-GX-A6TI-L- <b>X</b>	A	3/16" x 3/4"	Titanium	Left

The "**X**" in the part numbers listed above refer to the GX-Assist option you wish to be included with your kit. GX-Assist Units are available in 75N, 125N and 175N. For example, to order a SafetyStride kit with Y stirrups, aluminum uprights and a 125N GX-Assist for the right leg, your order number would be SCSY-9005-GX-A6-R-**125**.



### SafetyStride Kit with Stance Control Stirrup, Modular Double Action Ankle Joints and GX-Assist

Order No.	Joint Size	Upright Dimensions	Upright Material	Side
SCS <b>X</b> -9005-A6-R	A	3/16" x 3/4"	Aluminum	Right
SCS <b>X</b> -9005-A6S-R	A	3/16" x 3/4"	Stainless Steel	Right
SCS <b>X</b> -9005-A6TI-R	A	3/16" x 3/4"	Titanium	Right
SCS <b>X</b> -9005-A6-L	A	3/16" x 3/4"	Aluminum	Left
SCS <b>X</b> -9005-A6S-L	A	3/16" x 3/4"	Stainless Steel	Left
SCS <b>X</b> -9005-A6TI-L	A	3/16" x 3/4"	Titanium	Left

The "**X**" in the part numbers listed above refer to the stirrup size you wish to be included with your kit. Stirrups are available in 9", 10" and 11" lengths. For example, to order a SafetyStride kit with aluminum uprights and a 9" stirrup for the right leg, your order number would be SCS**9**-9005-A6-R.



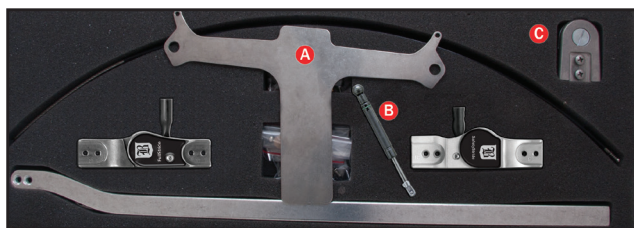

- A** — Stirrup
- B** — GX-Assist
- C** — Double Action Ankle Joints

### SafetyStride Kit with Stance Control Stirrup, Modular Double Action Ankle Joints and GX-Assist

Order No.	Joint Size	Upright Dimensions	Upright Material	Side
SCSX-9005-GX-A6-R-X	A	3/16" x 3/4"	Aluminum	Right
SCSX-9005-GX-A6S-R-X	A	3/16" x 3/4"	Stainless Steel	Right
SCSX-9005-GX-A6TI-R-X	A	3/16" x 3/4"	Titanium	Right
SCSX-9005-GX-A6-L-X	A	3/16" x 3/4"	Aluminum	Left
SCSX-9005-GX-A6S-L-X	A	3/16" x 3/4"	Stainless Steel	Left
SCSX-9005-GX-A6TI-L-X	A	3/16" x 3/4"	Titanium	Left

The "X's" in the part numbers listed above refer to the stirrup size and the GX-Assist option you wish to be included with your kit. Stirrups are available in 9", 10" and 11" lengths and GX-Assist Units are available in 75N, 125N and 175N. For example, to order a SafetyStride kit with aluminum uprights, 9" stirrup, and a 125N GX-Assist for the right leg, your order number would be SCSX9-9005-GX-A6-R-125.

## SafetyStride™ Custom KAFO's

Order No.	Description
321	SafetyStride KAFO
321-GX	SafetyStride KAFO w/ GX-Assist
321-PP	PrePreg SafetyStride KAFO
321-GX-PP	PrePreg SafetyStride KAFO w/ GX-Assist





# Stride Accessories



## Model GX-Assist

For individuals with significant weakness of hip musculature, the FullStride and SafetyStride may be ordered with a GX-Assist option that incorporates a pneumatic spring on the lateral or medial joint unit to assist in knee extension during the swing phase of gait. Available with your choice of a 75N, 125N (for standard applications), or 175N pneumatic spring, the GX-Assist can also be retrofit to existing FullStride and SafetyStride KAFO's.

## GX-Assist Add-On Kit

Order No.	Description	Side
9006-GX-A-R-X	GX-Assist Kit for FullStride A size (3/16" x 3/4")	Right Lateral
9006-GX-A-L-X	GX-Assist Kit for FullStride A size (3/16" x 3/4")	Left Lateral
9006-GX-B-R-X	GX-Assist Kit for FullStride B size (3/16" x 5/8")	Right Lateral
9006-GX-B-L-X	GX-Assist Kit for FullStride B size (3/16" x 5/8")	Left Lateral
9005-GX-A-R-X*	GX-Assist Kit for SafetyStride (3/16" x 3/4")	Right Medial
9005-GX-A-L-X*	GX-Assist Kit for SafetyStride (3/16" x 3/4")	Left Medial

The "X" in the part numbers listed above refer to the GX-Assist option you wish to be included with your add-on kit. GX-Assist Units are available in 75N, 125N and 175N. For example, to order a GX-Assist Kit for an A size FullStride with a 75N GX-Assist Unit for the right leg, your order number would be 9006-GX-A-R-75.

## Conversions

Pressurization Force (N)	Torque (in-lbf)	Band Color
75N	17	Blue
125N	28	Green
175N	39	No Band



\*When using the GX-Assist kit with the SafetyStride Stance Control System, the GX-Assist Unit must be attached to the medial side of the orthosis.

### Modular Double Action Ankle Joints

Our modular Slim Line double action ankle joints are optimized with pins in the anterior channels and springs in the posterior channels to provide you with an appropriate ankle joint setup for use with our Stride systems.



#### Modular Double Action Ankle Joints

Order No.	Joint Size	Recess	Material
SLM-2825-A	A	3/4"	Stainless Steel
SLM-2825-B	B	5/8"	Stainless Steel
ASLM-2825-A	A	3/4"	Aluminum
ASLM-2825-B	B	5/8"	Aluminum

### Stance Control Stirrups

To further increase your design options for our Stride stance control systems, we have developed two Slim Line double action stirrups that can be connected directly to the Stride cabling system.



#### Stance Control Y Stirrup Only

Order No.	Joint Size	Material
SC-SL2810-A-Y	A	Stainless Steel

#### Stance Control Stirrup Only

Order No.	Length	Material
SC-SL2800-X9	9"	Stainless Steel
SC-SL2800-X10	10"	Stainless Steel
SC-SL2800-X11	11"	Stainless Steel

### Lamination Uprights

To assist you with laminating, we have also developed lamination uprights for use with our Stride stance control knee joints and modular double action ankle joints.

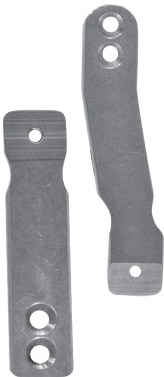

#### Knee and Ankle Lamination Uprights

Order No.	Bar Width	Description
LK-A#7	3/4"	Proximal Upright
LK-A#8-L	3/4"	Distal Upright - Left
LK-A#8-R	3/4"	Distal Upright - Right
LK-B#7	5/8"	Proximal Upright
LK-B#8-L	5/8"	Distal Upright - Left
LK-B#8-R	5/8"	Distal Upright - Right
LA-A	3/4"	Ankle Joint Upright
LA-B	5/8"	Ankle Joint Upright

**Replacement Decals**

To enhance the overall look of your orthosis, we have created a set of knee joint decals for you to apply. We recommend you apply the decals after the fitting and gait training process is complete.



**FullStride Decals**



**SafetyStride Decals**

**Decals (Sold in Sets of 4)**

Order No.	Joint Size	Description
9006-A-Decals	A	FullStride “A” Size Decals
9006-B-Decals	B	FullStride “B” Size Decals
9005-A-R-Decals	A	SafetyStride Decals - Right
9005-A-L-Decals	A	SafetyStride Decals - Left



**P:** 800-521-2192 • 248-588-7480

**F:** 800-923-2537 • 248-588-2960

**Central Fabrication**

**F:** 248-588-4555

**BeckerOrthopedic.com**   